

**BYLAW NO 1547-02
OF THE
CITY OF WETASKIWIN
IN THE PROVINCE OF ALBERTA**

A BYLAW TO AMEND THE "ASPEN RIDGE AREA STRUCTURE PLAN."

WHEREAS pursuant to the Municipal Government Act, Chapter M-26, R.S.A. 2000, as amended, the Council of the City of Wetaskiwin may by Bylaw adopt or amend an Area Structure Plan.

AND WHEREAS, pursuant to the Municipal Government Act, Chapter M-26, R.S.A. 2000, as amended, Council has deemed it expedient and proper to amend the Aspen Ridge Area East Structure Plan Bylaw to include the framework for subsequent subdivision and development of Lot 3, Block 14, Plan 922-2391 and to ensure it is carried out in an orderly fashion.

NOW THEREFORE, the Municipal Council of the City of Wetaskiwin duly assembled hereby enacts as follows:

1. That Map 1 of the Aspen Ridge East Area Structure Plan Bylaw, being bylaw 1431-99 be amended to add all lands in Block 14, lying east of 47th Street, lying south of Northmount Drive, lying west of Caledonia Street and North of 64th Avenue.
2. That Map 2 of the Aspen Ridge East Area Structure Plan Bylaw, being bylaw 1431-99, be amended, regarding Block 14.
3. This Bylaw shall come into full force and effect on the date of the final passing thereof.

READ a first time this __15th__ day of __October__ 2002.

READ a second time this __28th__ day of __October__ 2002.

READ a third time and duly passed this __28th__ day of __October__ 2002.

Original Signed
MAYOR

Original Signed
CHIEF ADMINISTRATIVE OFFICER

Map 1 – SUBJECT AREA
Aspen Ridge – East Area Structure Plan

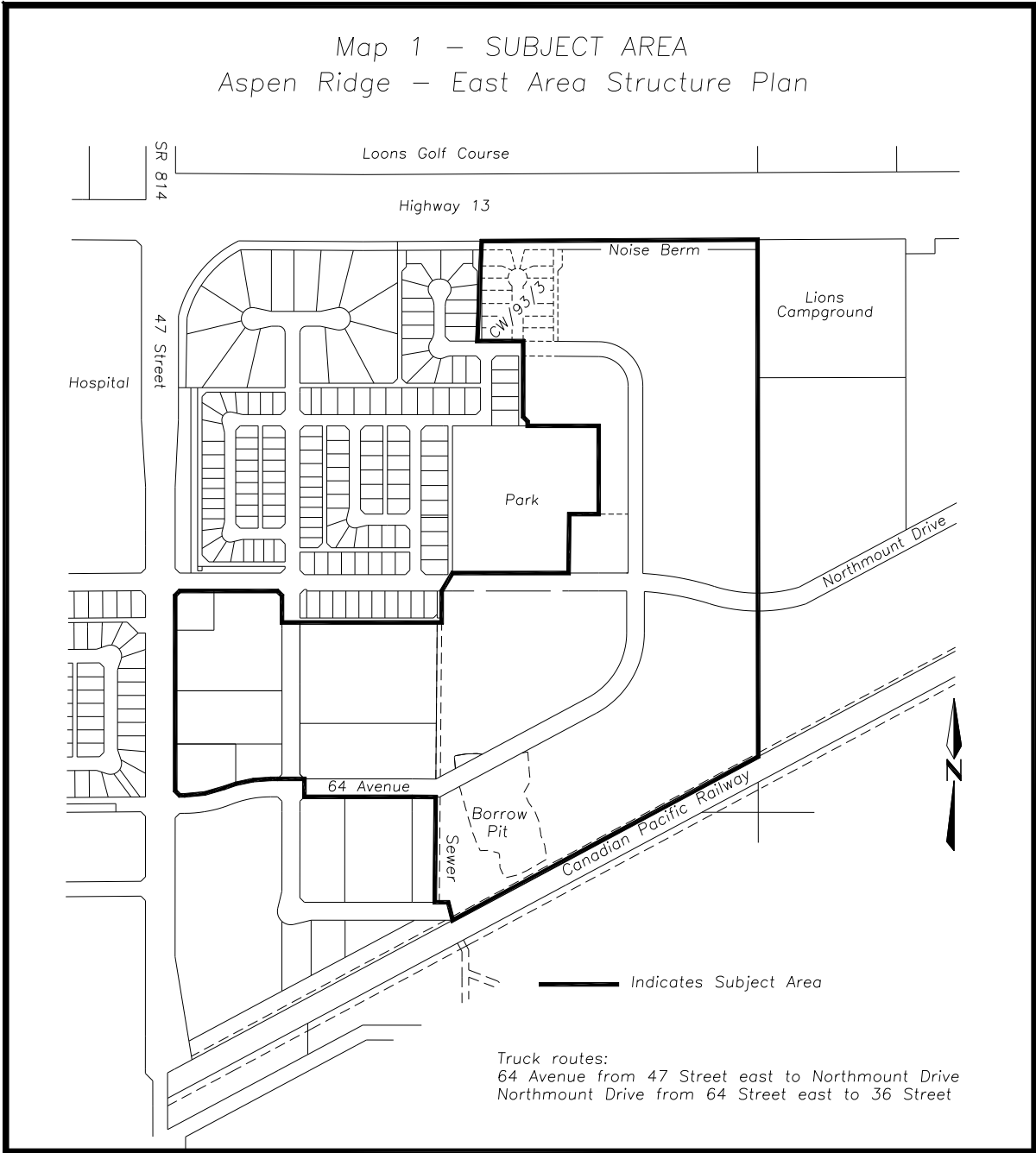

Map 2 – FUTURE LAND USE
Aspen Ridge – East Area Structure Plan

