

Amended by
1547-02

BY-LAW NO. 1431-99
OF THE
CITY OF WETASKIWIN
IN THE PROVINCE OF ALBERTA

A BY-LAW TO ADOPT AN AREA STRUCTURE PLAN FOR A PORTION OF NW-24-46-24-W4.

WHEREAS pursuant to the Municipal Government Act, Chapter M-26.1, R.S.A. 1994, as amended, the Council of the City of Wetaskiwin may by by-law adopt an Area Structure Plan.

AND WHEREAS, pursuant to the Municipal Government Act, Chapter M-26.1, R.S.A. 1994, as amended, Council has deemed it expedient and proper to adopt an Area Structure Plan to provide framework for subsequent sub-division and development within an area of land and to ensure it is carried out in an orderly fashion.

NOW THEREFORE, the Municipal Council of the City of Wetaskiwin duly assembled hereby enacts as follows:

1. That this By-law shall be cited as the Aspen Ridge East Area Structure Plan By-law.
2. That Map 1, attached, forms part of this by-law and indicates the subject area controlled by this by-law.
3. That Map 2, attached, forms part of this by-law and indicates the general land uses and the major roadway alignments within the subject area.
4. That for the purposes of this by-law "Low Rise" means less than three storeys in height.
5. That this by-law may be amended from time to time following the same procedures outlined in the Land Use By-law in place at the time, for land use amendments.
6. That all information on the Maps 1 & 2 related to land outside the subject area is unofficial.
7. This By-law shall come into full force and effect on the date of signing.

READ a first time this 22nd day of February, 1999.

READ a second and third time this 8 _____ day of March _____, 1999.

Original Signed _____
MAYOR

Original Signed _____
CITY CLERK

Map 1 - SUBJECT AREA
Aspen Ridge - East Area Structure Plan

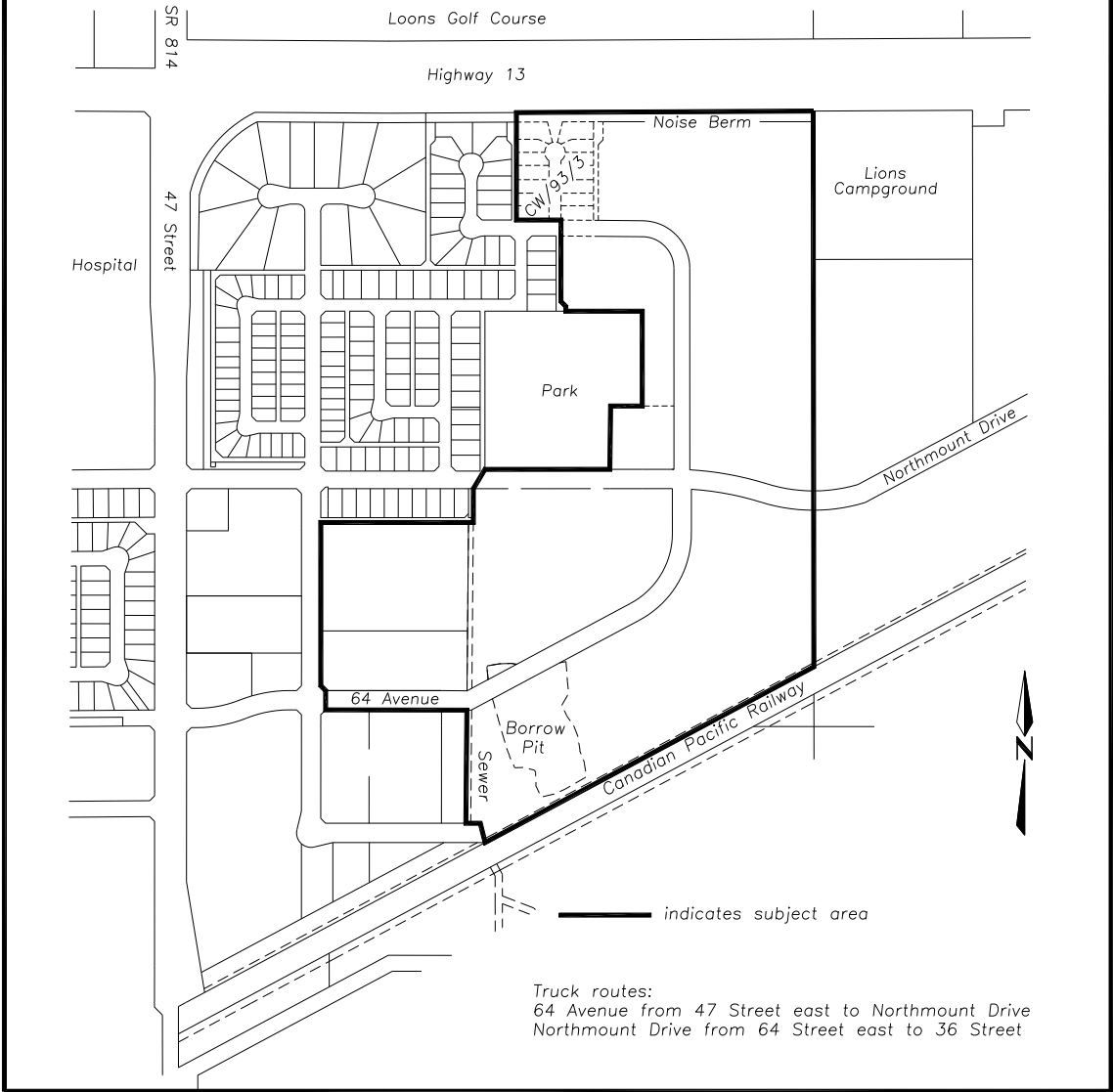

Truck routes:
64 Avenue from 47 Street east to Northmount Drive
Northmount Drive from 64 Street east to 36 Street

Map 2-FUTURE LAND USE

Aspen Ridge – East Area Structure Plan

